

"COVINGTON II"

Standard First (Slab)

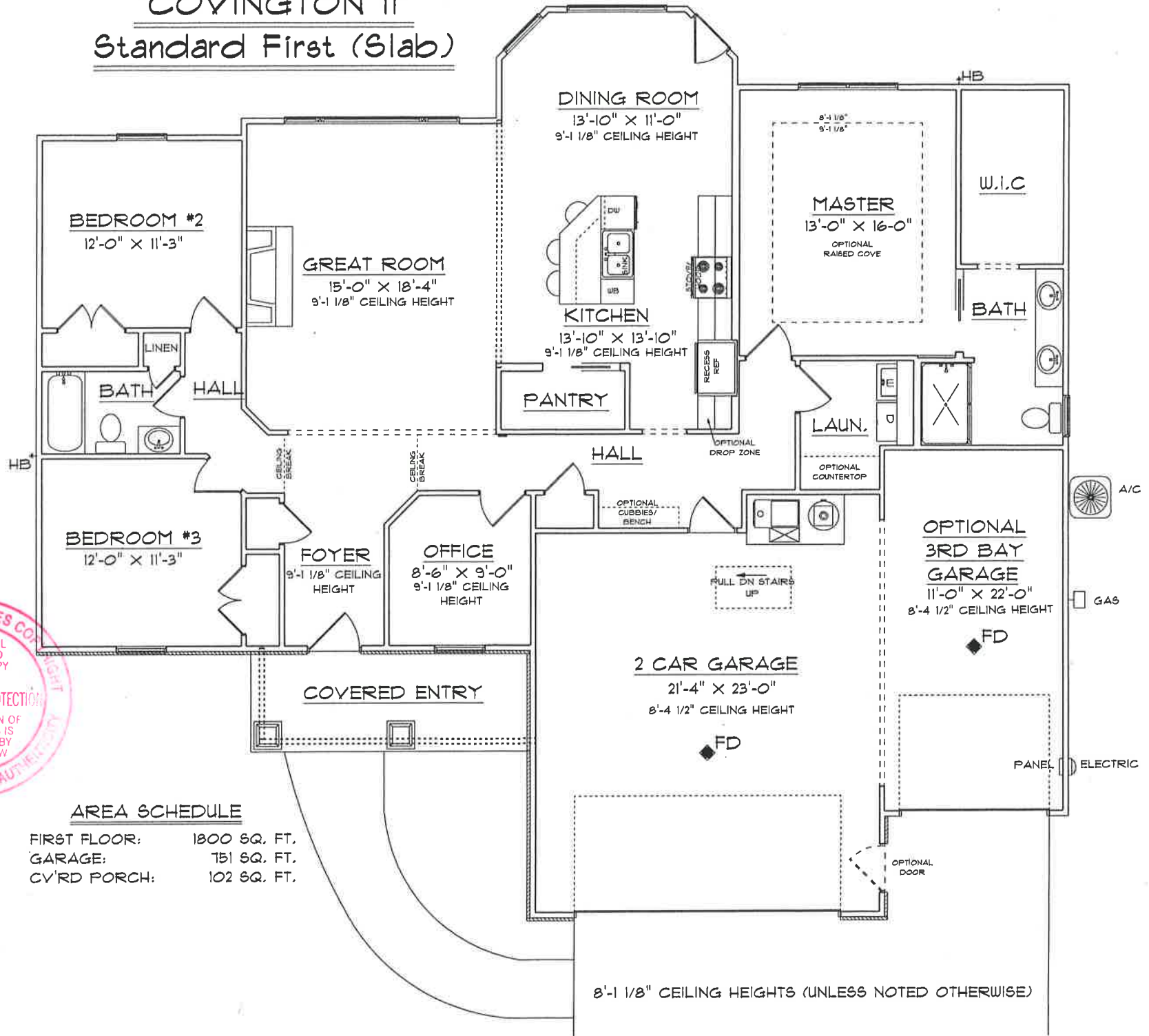

AREA SCHEDULE

FIRST FLOOR:	1800 SQ. FT.
GARAGE:	751 SQ. FT.
CV'RD PORCH:	102 SQ. FT.

8'-1/8" CEILING HEIGHTS (UNLESS NOTED OTHERWISE)

