

**GENERAL NOTES**

- \* 8'-1 1/8" CEILING HT.
- Unless Noted
- \* 4" EXTERIOR WALLS-Typical

- MAIN LEVEL : 2,448 sf
- Opt. LOFT : 397 "
- GARAGE : 822 "
- BSMNT LEV. : 1,841 "

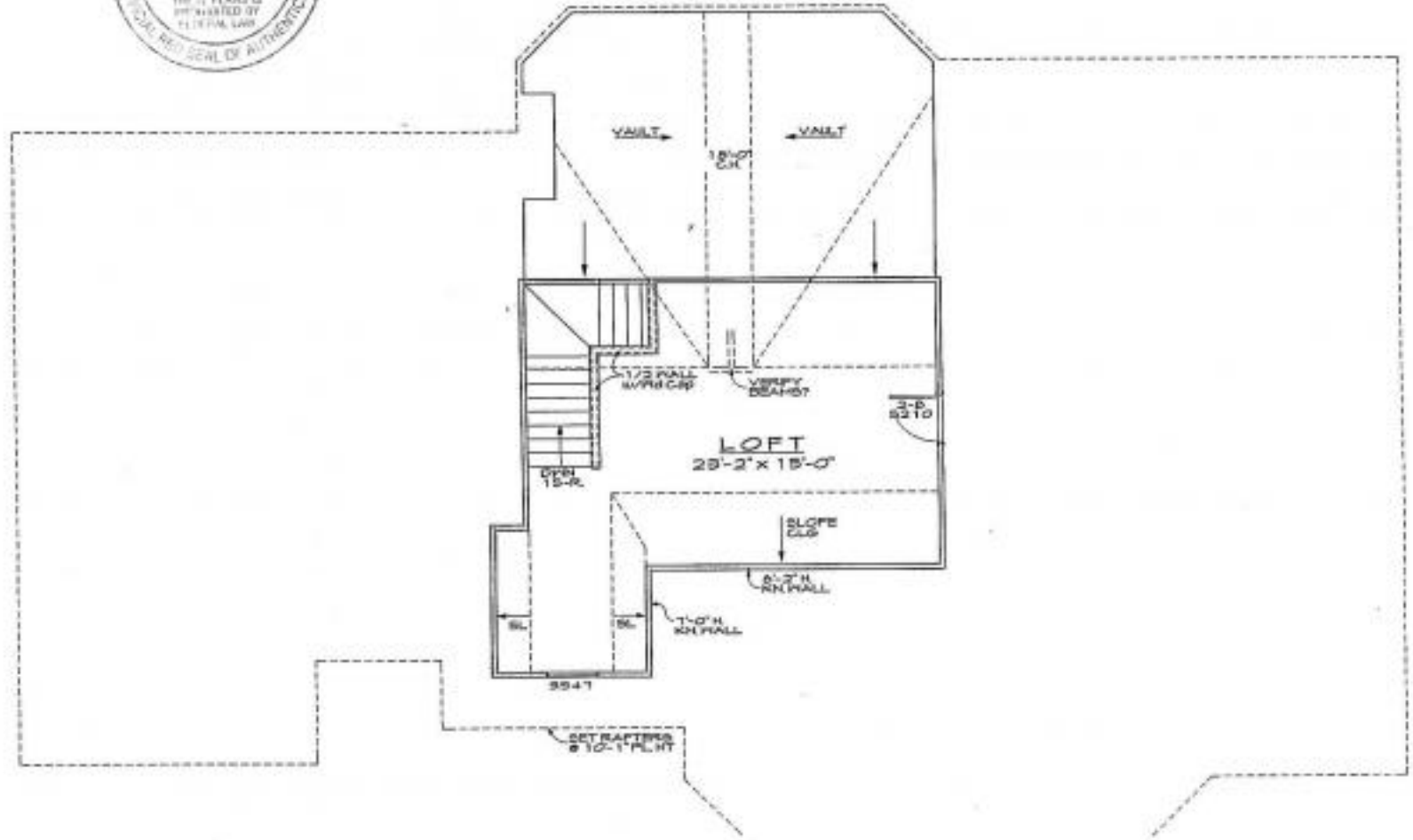



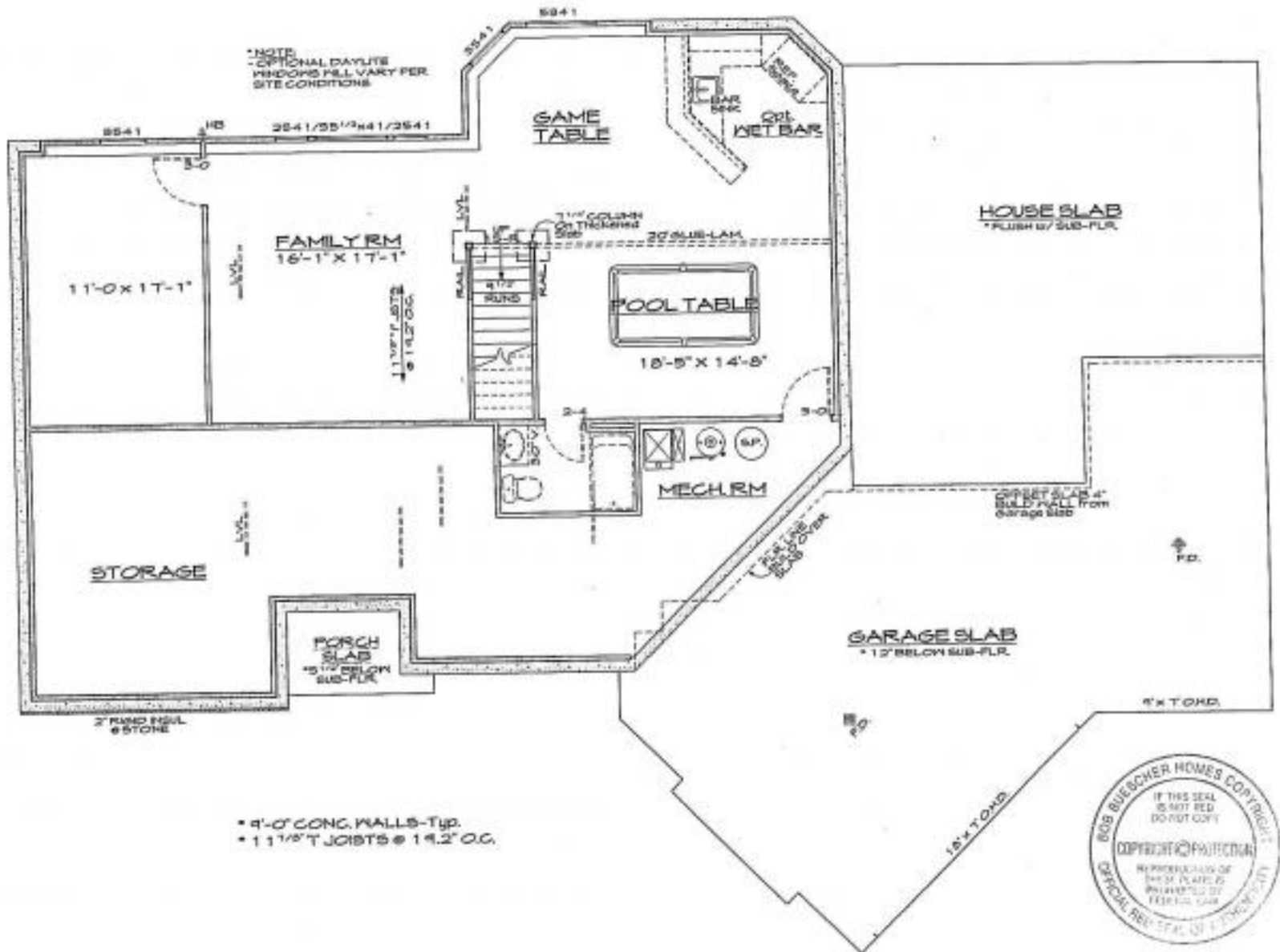

- 9'-0" CONG. WALLS-TYP.
- 11'-0" T JOIST @ 14.2" O.C.

